

Removing the vacuum pipe

1) First, remove the cable from the gauge.

It could have a screw at the top. Unscrew it, and remove the connector

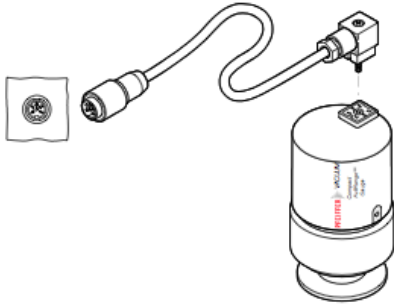

Junction to disassemble

The one in the "T" piece where the vacuum pipe is connected



Disassembling the pipe junction

- 1) Loose the purge screw at the back of the pump. This will remove the vacuum of the pipe and the pump, and make the disassembling of the junction easier. When you are loosening the screw you will hear air flowing into the pump. Tight it again after the air flow stops.
- 2) Start disassembling the junction.
Loose the nut until you can remove the clamp from the line. With the other hand, or with some help hold the pipe line in place, so the Oring does not fall.

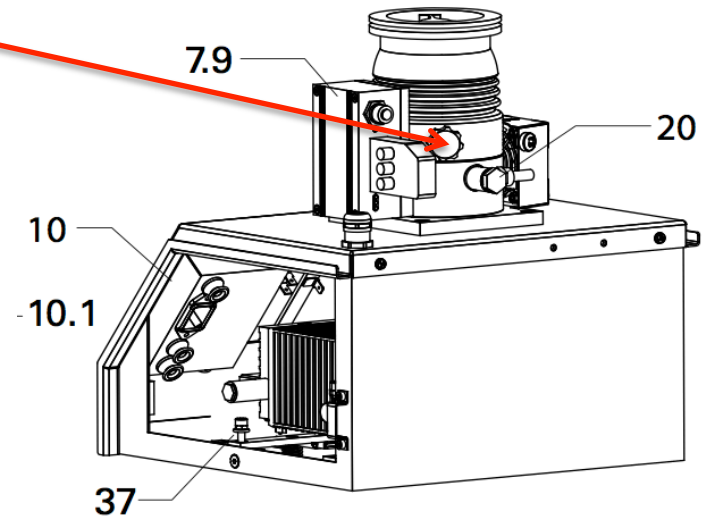
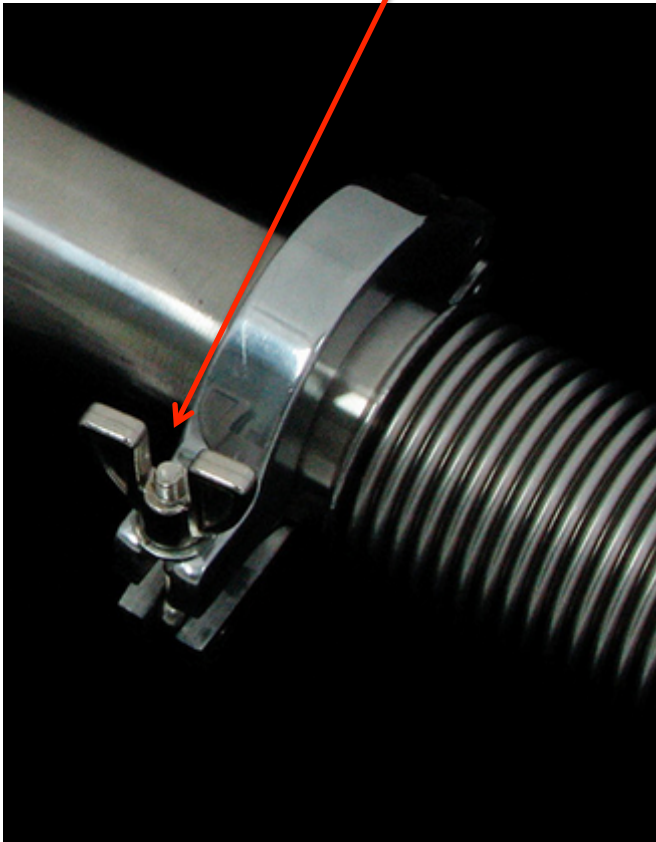

Removing the backing pump

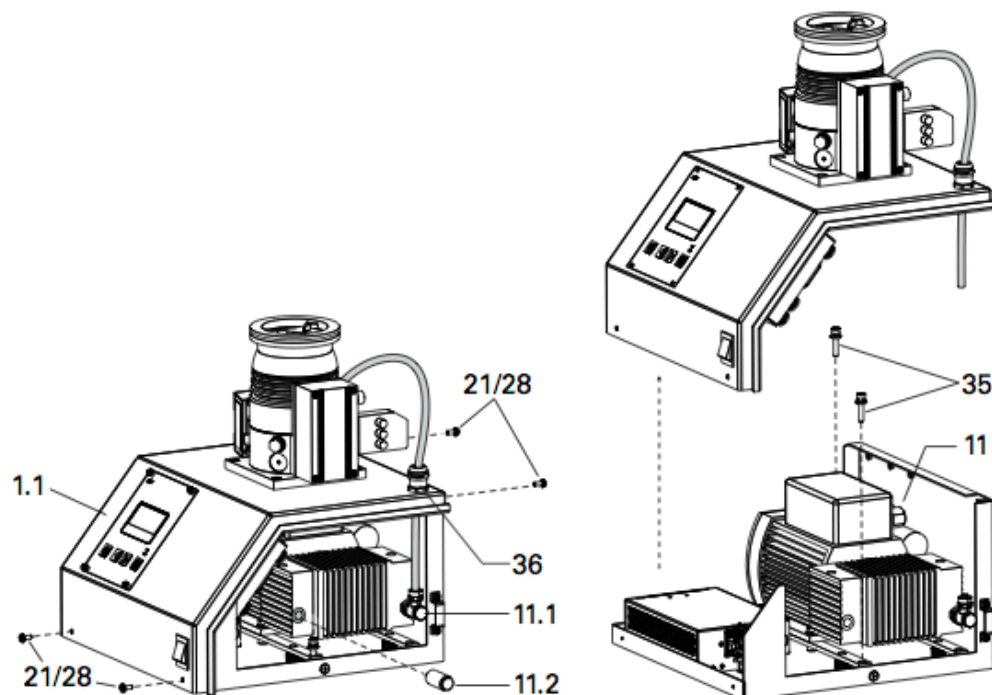

Fig. 9: Disassembly of the diaphragm pump from the pumping stand frame

1.1	Casing	11.2	Exhaust silencer	35	Cylinder screw
11	Backing pump	21	Casing screw	36	Clamping screw
11.1	Vacuum connection backing pump	28	Washer		

- ➔ Detach the fore-vacuum line from the vacuum connection of the diaphragm pump and take it off.
 - Do not kink or damage the fore-vacuum hose.
- ➔ Unscrew and remove the casing screws and washers on the front and rear of the pumping stand frame.
- ➔ Take off the casing with turbopump, display and control unit and relay box from the pumping stand frame.
 - Observe the connection cables!
- ➔ Unscrew the exhaust silencer by hand from the backing pump.
- ➔ Unscrew the two cylinder screws 35 (Allen head) from the bottom plate of the pumping station so that the backing pump is loosened.
- ➔ Lift out the backing pump above the top of the pumping station frame.

Instructions for step 1

- ➔ Detach the fore-vacuum line from the vacuum connection of the diaphragm pump and take it off.
 - Do not kink or damage the fore-vacuum hose.

1) Find the wrench for the nut.

2) Loose the nut. Counterclockwise, looking from the top. It looks like a bronze material (soft material). **Try to remember the strength you use to loose it, it should use the same to tight it after all.**

3) After loosening the nut, you will see that the plastic pipe is plugged into the conical feature. Remove the plastic pipe carefully using hands. **Remember how deep was the pipe into the canonical peak, you may want to take a pic of it.**

